

Ink drawing illustration from
Go With Me: 50 Steps to Landscape Thinking

JACQUES ABELMAN
GROUNDCONDITION
LANDSCAPE ARCHITECTURE
SELECTED PROJECTS &
TEACHING PORTFOLIO

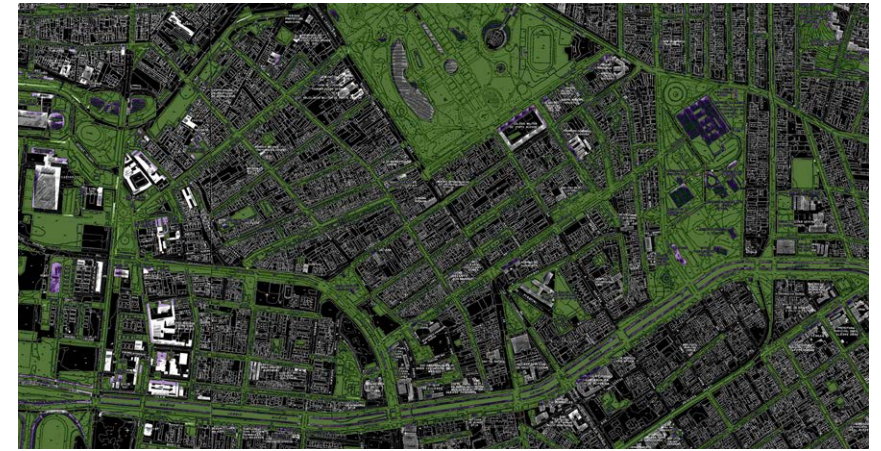

Cultivating the City envisions the potential for multifunctional productive green infrastructure in the city of Porto Alegre, Brazil. The lacelike network is based on an urban analysis matched to underlying ecological systems and typologies of urban agriculture and agroforestry. The plan investigates urban food systems and negotiates social, economic, and spatial differences to create an integrated strategy for sustainable and equitable cities.

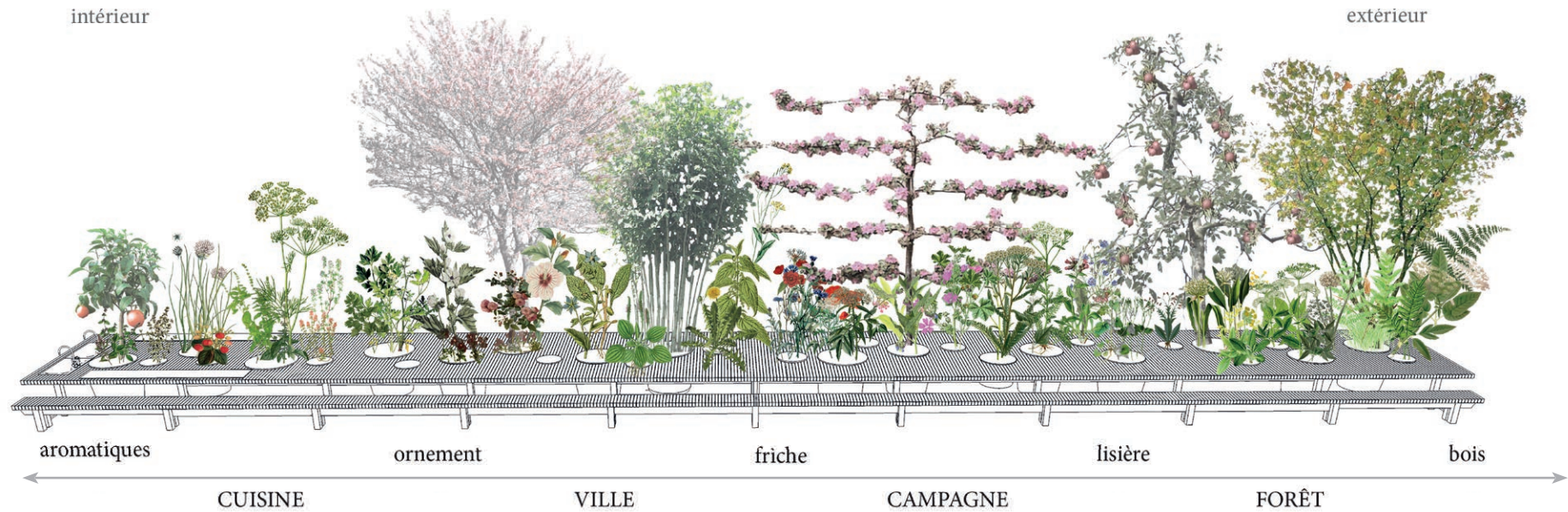

Client: Par(c)kdesign Landscape Biennial for the City of Brussels

I designed and constructed The Landscape Table to contain four different landscapes of edible plants and to seat 100 people. It celebrates the Par(c)kdesign Landscape Biennial theme of "from landscape to table." An outdoor kitchen integrated into one end is a focal point for community events and workshops. The gradient of culinary species goes from herb garden to native ecosystem. The table is also used as a learning platform by local schools.



Client: City of Brussels, Institut Bruxellois pour la Gestion de l'Environnement

As co-curator of the biennial, I developed a working urban farm on the new park site of Tour & Taxi. I collaborated to create and organize this international event around urban agriculture, food systems, and social solidarity. The urban farm, run by community groups, was divided into sections exploring food production, waste recycling, bee keeping, water harvesting and urban livestock. Installations by artists and a calendar of events and performances created a yearlong public event.

SELECTED PROJECT

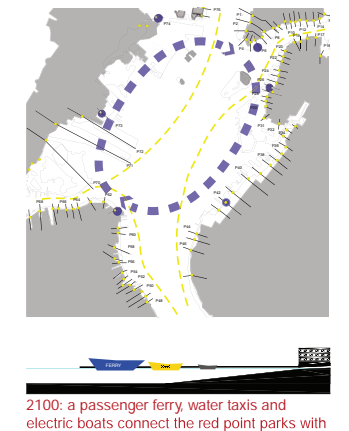
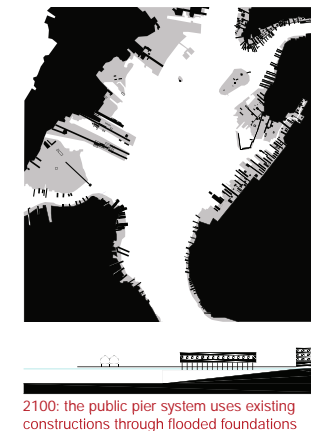
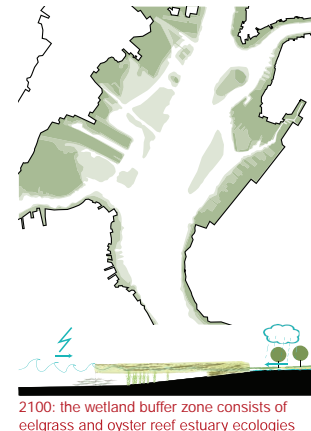
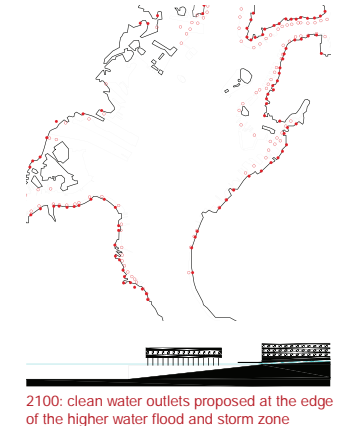
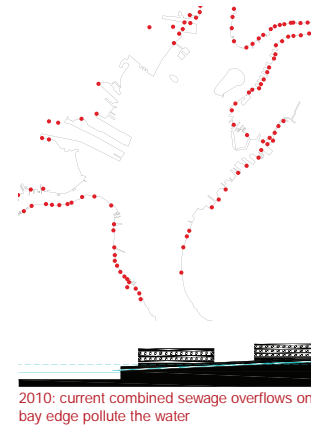

Client: Amsterdam Academy of Architecture and AIA New York and Amsterdam Center for Architecture

Climate change will demand a radical adaptation strategy around the Upper New York Bay. Red Point Parks proposes a network of access points around an altered urban edge. Wetlands will occupy flood zones, creating a living storm buffer. The greenline network will connect inner urban areas to the bay and absorbs rain water, diverting it from the sewage system. The aquapuncture of the parks will respond to climate change and transform the city, creating a new urban edge and an estuary whose heart is pristine water.

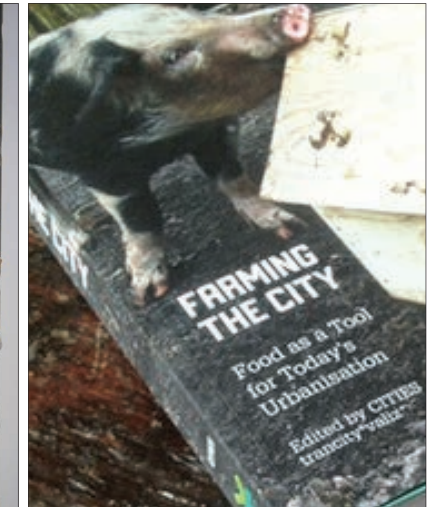
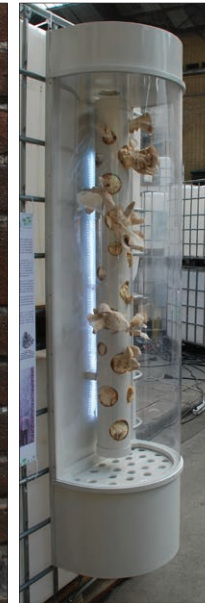
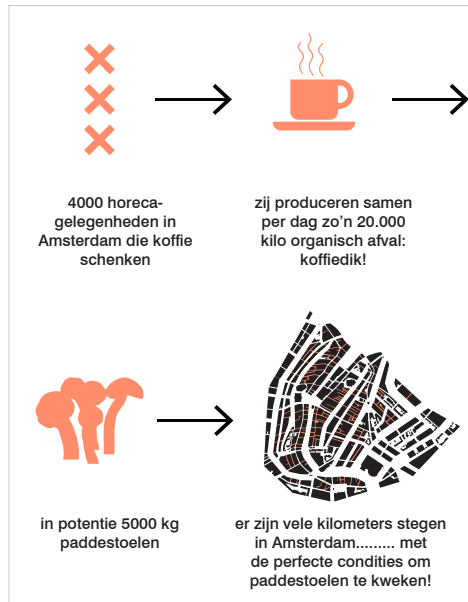

Clients: Amsterdam Center for Architecture, Amsterdam Fund for the Arts, CITIES Foundation

Vertical mushroom urban farming captures parts of the city's waste stream, using coffee grounds, cardboard and paper as substrates for cultivating oyster mushrooms. The project makes the process of recuperation, transformation, and harvesting visible by locating it in public space. The vertical growing system uses recycled plastic cylinders on the walls of narrow alleys in inner-city Amsterdam and installations in urban parks. Winner of the 2012 Food and Architecture fair and published in Farming the City.

SELECTED PROJECT

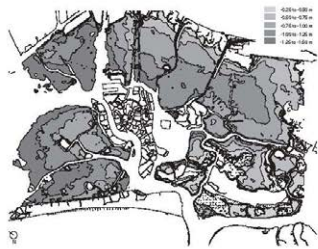
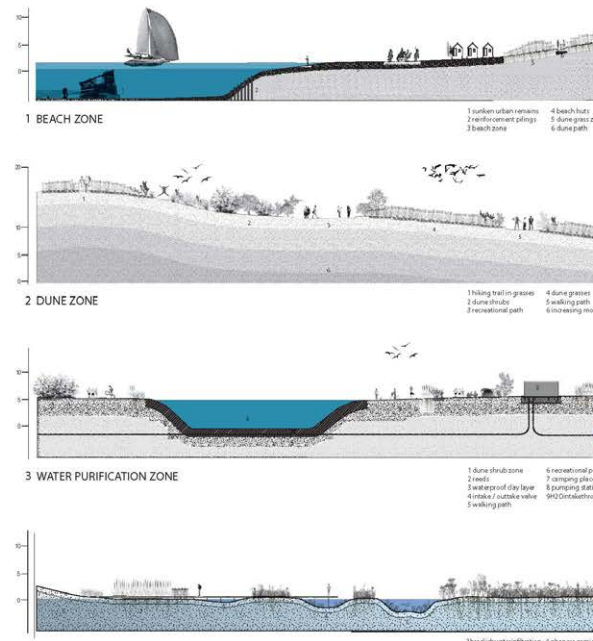
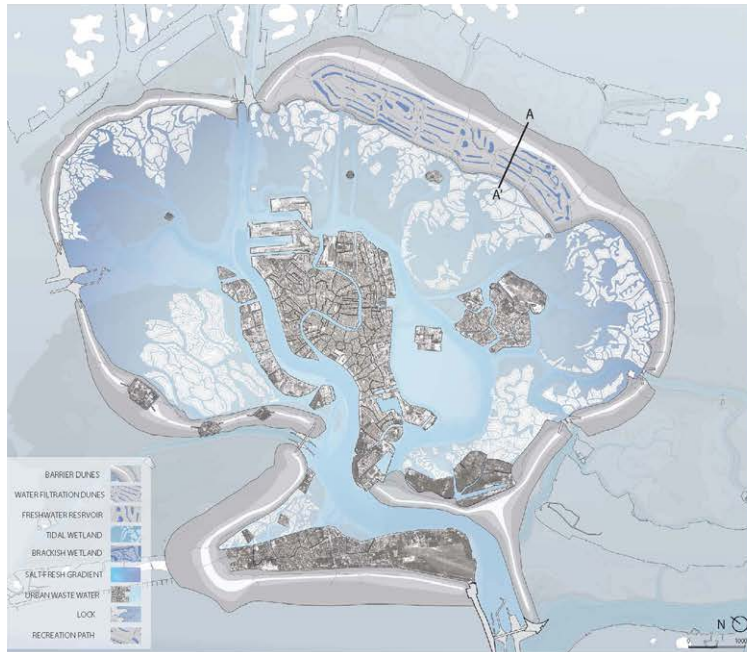

DUNE BARRIER / LANDSCAPE PARK SECTION



Client: CityVision Competition

Scientists project the permanent flooding of Venice in 100 years. The Serenissima plan augments the existing underwater topography of the lagoon, creating a ring dike system. Opening locks allows fresh sea water into the city and flushes water outwards into new tidal marshlands or barene around the urban core. Brackish water is filtered and pumped through the dunes, creating fresh drinking water. The ring landscape creates new biological, recreational and urban potentials while safeguarding the city.

SELECTED PROJECT

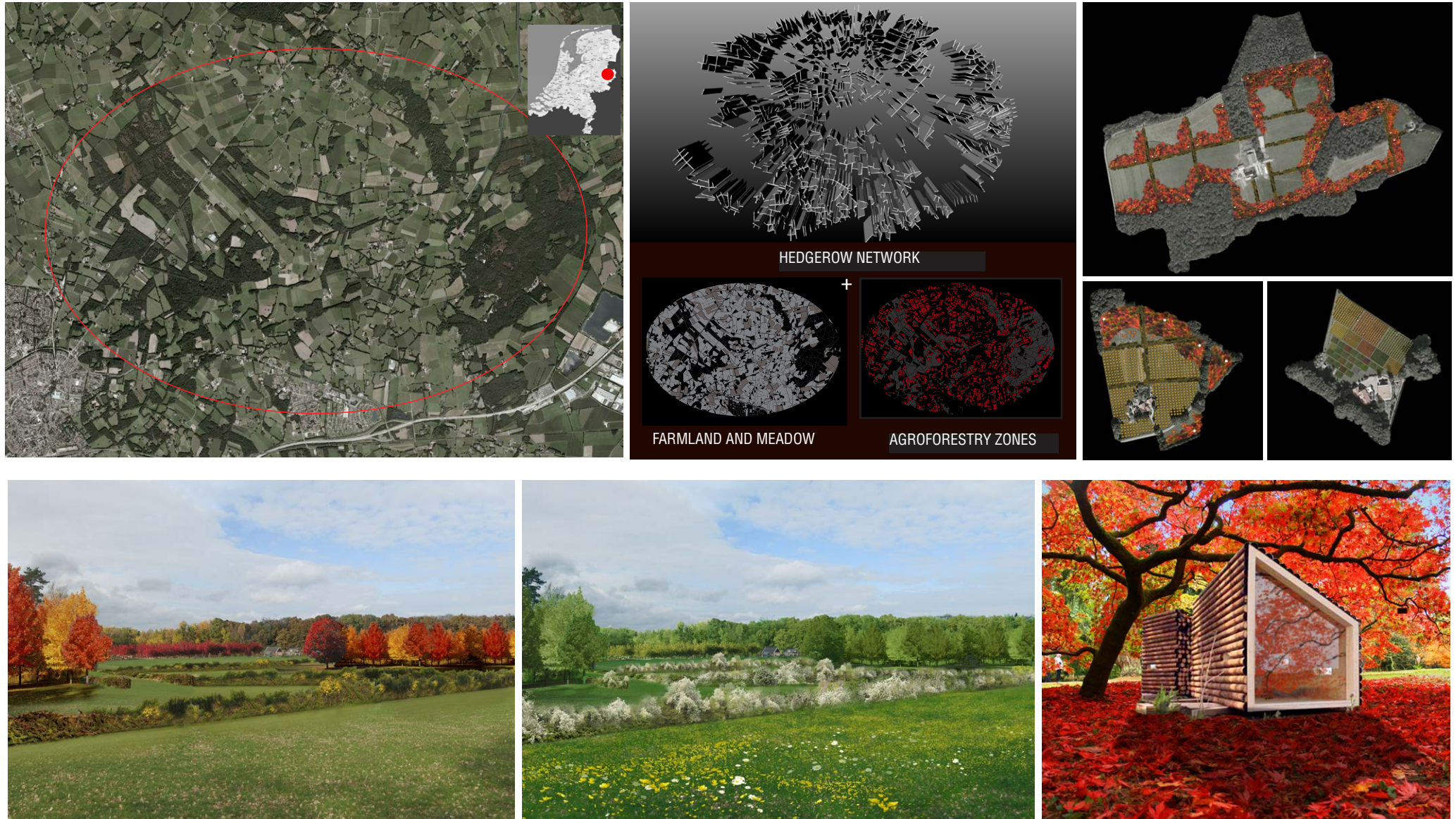

Client: The Municipality of Oldenzaal in the Twente Region, the Netherlands

Farming in the Netherlands creates a vital cultural landscape but critically needs renewal—new economic activities and more biodiversity. Hedgerow Harvest first creates a network of hedgerows on existing parcel boundaries. Agroforestry with native species and *Acer saccharum* is then established. Vacation cabins are located in the green “chambers” formed by the agroforestry and hedgerow system, also creating a new source of income. Buffer zones, spatial rhythms and the corridor effect create and maintain higher levels of biodiversity.

SELECTED PROJECT

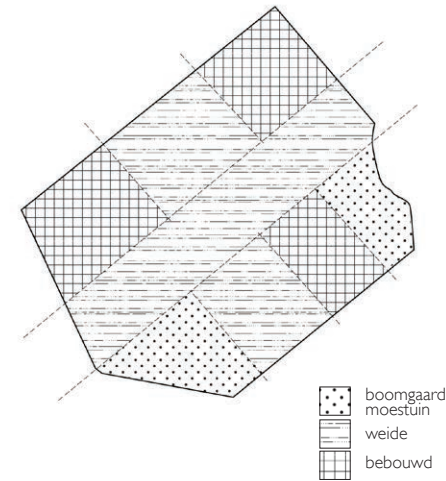

Drie Type Ensembles: *Gebouw + Tuin + Landschap* =

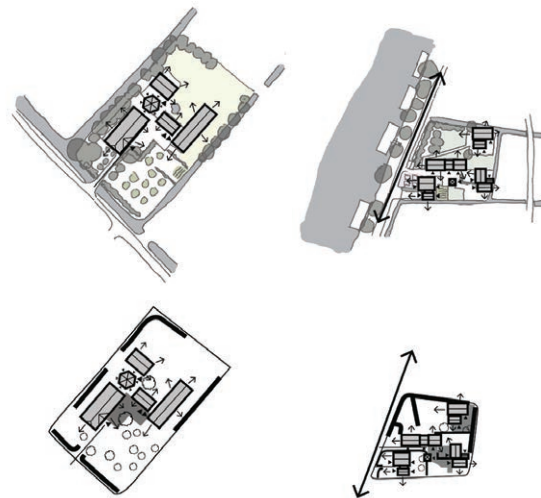
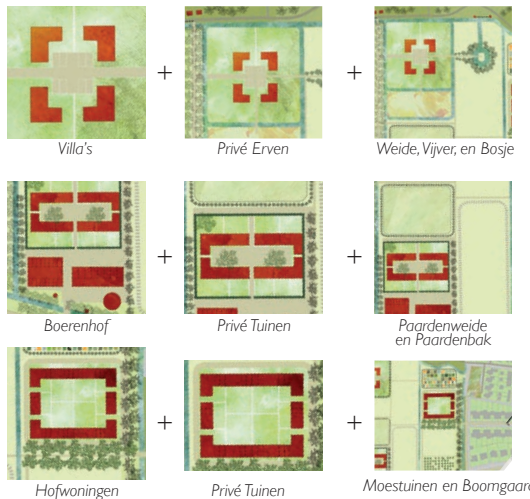

Client: Landscape Architects for S.A.L.E. (Urbanism, Architecture, Landscape, and Ecology), private developer

The Vecht area near Utrecht features historical estates and very old working farms. As a lead designer on this proposal for a new development on agricultural land, my team analyzed spatial qualities of regional estates and farms and catalogued typologies of gardens. We proposed mixed-use social housing with orchards and vegetable gardens, clusters focused on horse owners, and garden villas. The spatial ensemble features large amounts of public space accessible for all in the area.

SELECTED PROJECT

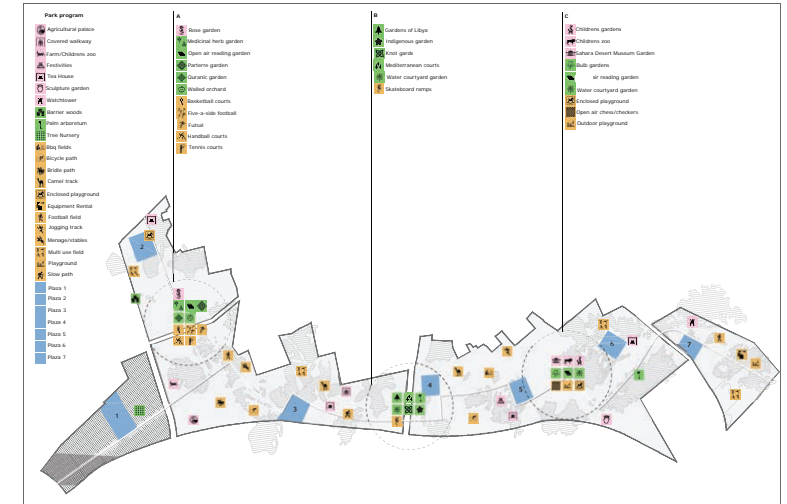
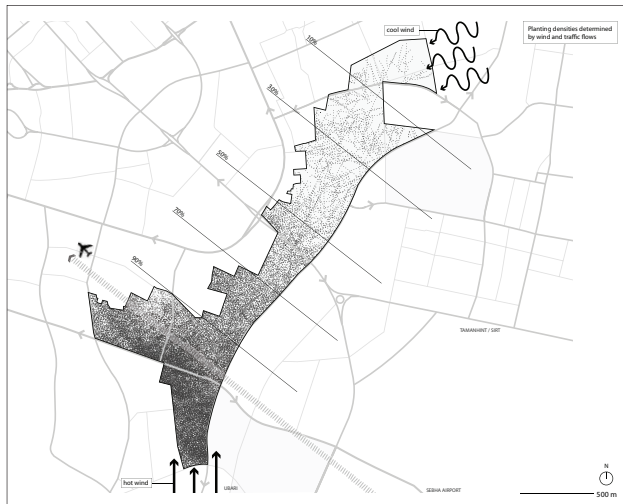
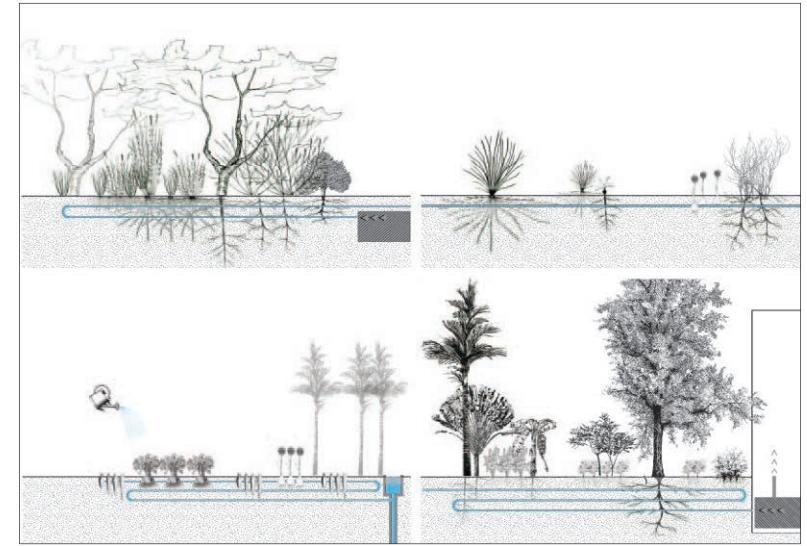
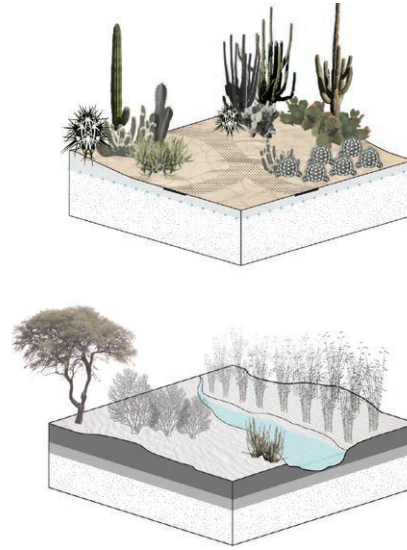

Client: Inside Outside and Office for Metropolitan Architecture

This conceptual masterplanning project for two Saharan gateway cities was based on renewing landscape structures. My team focused on water conservation, indigenous plants, alternative energy technologies and large-scale landscape approaches for repairing damaged ecosystems. We developed strategies for new landscape elements, public spaces, and programming. We also integrated landscape-based cultural and recreational activities into the urban plan.

SELECTED PROJECT

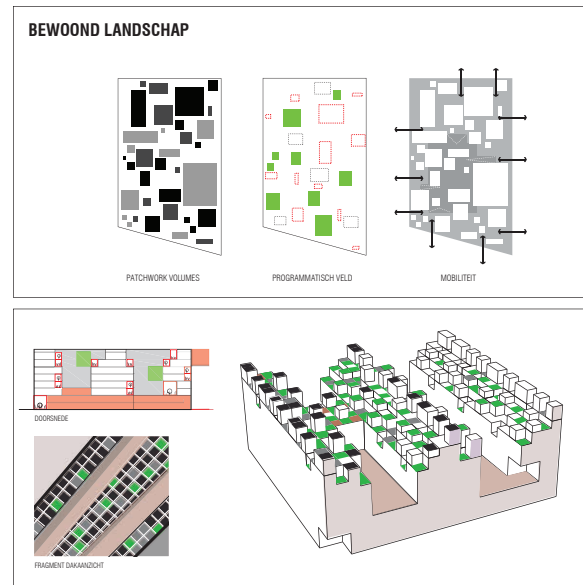
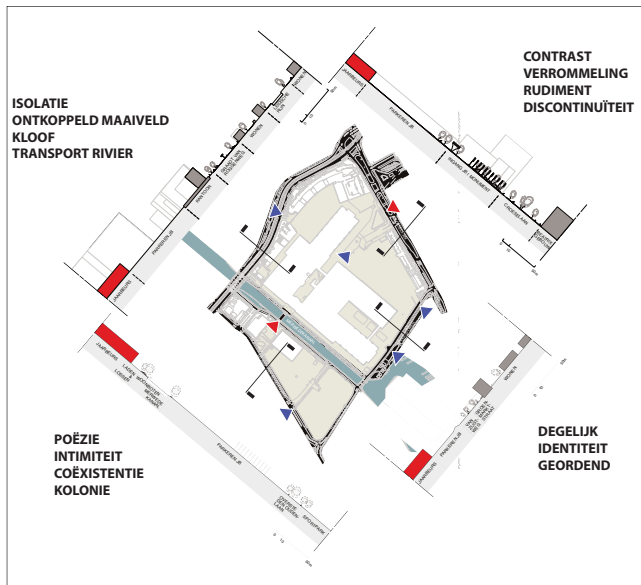
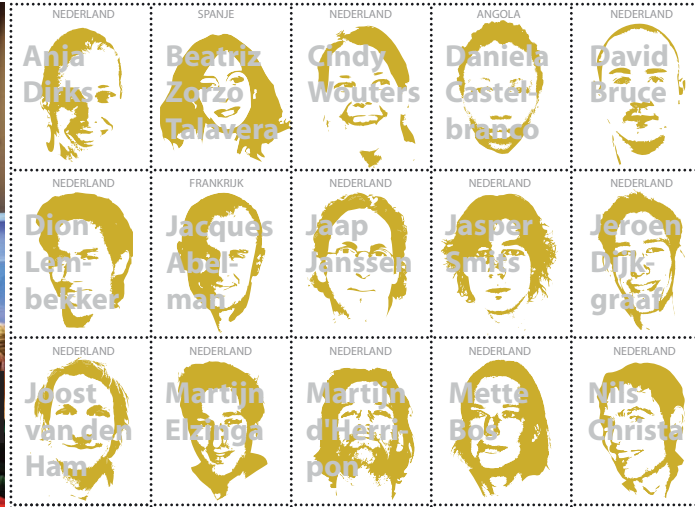

Client: Office of the Architecture Commission of the Netherlands

LAB 01 was a research lab for urban strategies initiated by the Dutch government during the economic crisis of 2009. As the only landscape architect in a group of architects, I researched and designed public space within the six development scenarios that my team created for the city of Utrecht. My individual research focused on new forms of multifunctional green infrastructure in high density urban settings.

SELECTED PROJECT



Client: Urbania Hoeve, STROOM Architectural Center The Hague, FOODPRINT project

Foodscape Schilderswijk researches typologies of urban agriculture specifically for the Schilderswijk neighborhood in The Hague. Through urban analysis interventions such as espalier fruit fences, herb lawns and SPIN (small plot intensive) gardens are mapped onto the neighborhood. The intention is to activate vacant and under-used public spaces with edible infrastructure. The visual nature of the design research strategically communicates to a non-design audience.

Pays Landes Nature Côte d'Argent: Landscape as Economic and Social Generator

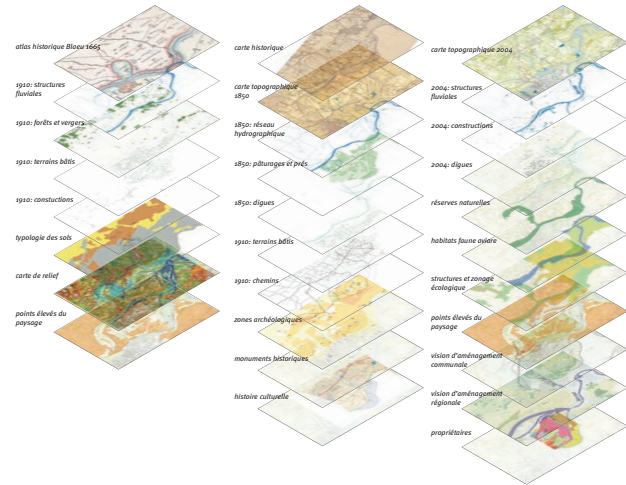
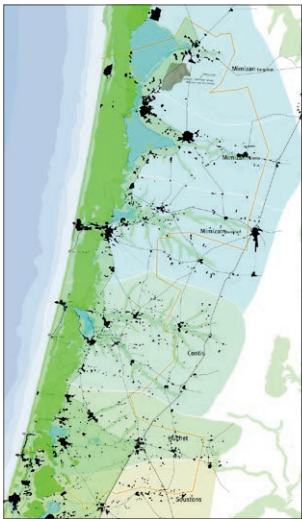

Amsterdam, the Netherlands and Mimizan, France 2008

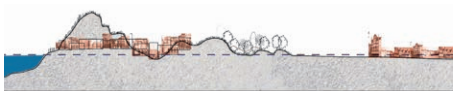

roupe France, les Landes - une protection aléatoire et poreuse



Mimizan Plage

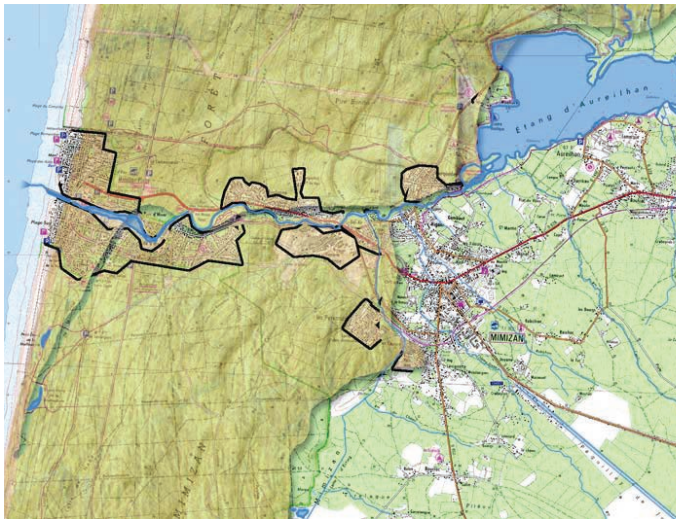

	nature & paysage	infrastructure publique	transport & réseaux	loisirs & tourisme
authenticité	<ul style="list-style-type: none">à l'heure actuelle les services publics sont dans les agglomérations, qui ont grand besoin de services de proximitéles services publics sont dans les agglomérations, qui ont grand besoin de services de proximitéles services publics sont dans les agglomérations, qui ont grand besoin de services de proximité	<ul style="list-style-type: none">à l'heure actuelle les services publics sont dans les agglomérations, qui ont grand besoin de services de proximitéles services publics sont dans les agglomérations, qui ont grand besoin de services de proximitéles services publics sont dans les agglomérations, qui ont grand besoin de services de proximité	<ul style="list-style-type: none">à l'heure actuelle les services publics sont dans les agglomérations, qui ont grand besoin de services de proximitéles services publics sont dans les agglomérations, qui ont grand besoin de services de proximitéles services publics sont dans les agglomérations, qui ont grand besoin de services de proximité	<ul style="list-style-type: none">à l'heure actuelle les services publics sont dans les agglomérations, qui ont grand besoin de services de proximitéles services publics sont dans les agglomérations, qui ont grand besoin de services de proximitéles services publics sont dans les agglomérations, qui ont grand besoin de services de proximité
innovation	<ul style="list-style-type: none">à l'heure actuelle les services publics sont dans les agglomérations, qui ont grand besoin de services de proximitéles services publics sont dans les agglomérations, qui ont grand besoin de services de proximitéles services publics sont dans les agglomérations, qui ont grand besoin de services de proximité	<ul style="list-style-type: none">à l'heure actuelle les services publics sont dans les agglomérations, qui ont grand besoin de services de proximitéles services publics sont dans les agglomérations, qui ont grand besoin de services de proximitéles services publics sont dans les agglomérations, qui ont grand besoin de services de proximité	<ul style="list-style-type: none">à l'heure actuelle les services publics sont dans les agglomérations, qui ont grand besoin de services de proximitéles services publics sont dans les agglomérations, qui ont grand besoin de services de proximitéles services publics sont dans les agglomérations, qui ont grand besoin de services de proximité	<ul style="list-style-type: none">à l'heure actuelle les services publics sont dans les agglomérations, qui ont grand besoin de services de proximitéles services publics sont dans les agglomérations, qui ont grand besoin de services de proximitéles services publics sont dans les agglomérations, qui ont grand besoin de services de proximité
diversité	<ul style="list-style-type: none">à l'heure actuelle les services publics sont dans les agglomérations, qui ont grand besoin de services de proximitéles services publics sont dans les agglomérations, qui ont grand besoin de services de proximitéles services publics sont dans les agglomérations, qui ont grand besoin de services de proximité	<ul style="list-style-type: none">à l'heure actuelle les services publics sont dans les agglomérations, qui ont grand besoin de services de proximitéles services publics sont dans les agglomérations, qui ont grand besoin de services de proximitéles services publics sont dans les agglomérations, qui ont grand besoin de services de proximité	<ul style="list-style-type: none">à l'heure actuelle les services publics sont dans les agglomérations, qui ont grand besoin de services de proximitéles services publics sont dans les agglomérations, qui ont grand besoin de services de proximitéles services publics sont dans les agglomérations, qui ont grand besoin de services de proximité	<ul style="list-style-type: none">à l'heure actuelle les services publics sont dans les agglomérations, qui ont grand besoin de services de proximitéles services publics sont dans les agglomérations, qui ont grand besoin de services de proximitéles services publics sont dans les agglomérations, qui ont grand besoin de services de proximité

Client: DS Landscape Architects for Pays Landes Nature Côte d'Argent, France

Large-scale regional planning and development project for the department of Les Landes south of Bordeaux. The analysis and plan features the landscape as the carrier of developmental schemes ranging from infrastructure and housing to tourism and new industrial activities. I developed detailed matrices as well as cartographic analyses for each landscape zone which provided strategic conclusions in terms of urbanism, landscape, infrastructure and economic activities.

SELECTED PROJECT



Client: SKOR (Foundation for Art in Public Space), Bureau Venhuizen, and STROOM Architectural Center The Hague

EELs investigate new ways of reusing agricultural waste and reactivating disused periurban agricultural landscapes. The modular architectural system made of biodegradable plastic tubing is filled with straw. The tubes function as lounging spaces and are inoculated with mushroom spores which later spread through the straw and earth while the bioplastics break down, helping to clean polluted soil on the site. The project addresses recreation, food production, and ecological cycles.

SELECTED PROJECT

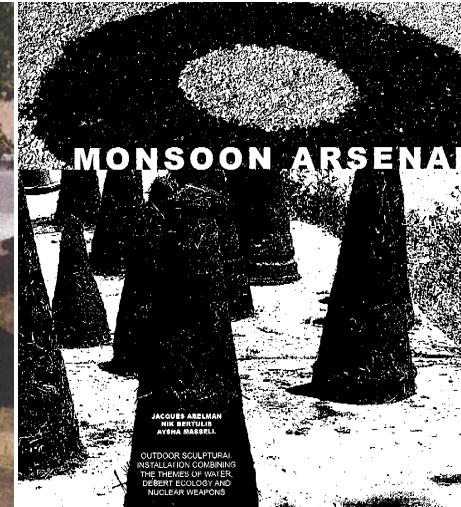

Client: Plan B Evolving Arts Center

The Monsoon Arsenal is a public art installation designed around the idea of contemplating security in the desert. Near the Los Alamos nuclear laboratories, I created a xeriscaped installation whose forms reflect the symbolism of technology while embodying ecological principles about water in the desert. Target-shaped drainage pools collect sparse desert rainwater while earthen warheads filled with fertilizer and seeds create an oasis of blooming desert flowers.

SELECTED PROJECT



Client: private commission

Named the "Clam" because of its shape, this structure is an experiment at the intersection of artistic practice and architectural thinking. A showcase for ecological building techniques, it emerges from a year-long dialogue with place and uses only materials present on site. This guest residence features a roof of native grasses over a roof of curved pine strips assembled with boat construction techniques. The post-and-beam structure frames straw bale and rammed earth walls covered with clay plaster and lime paint.

SELECTED PROJECT

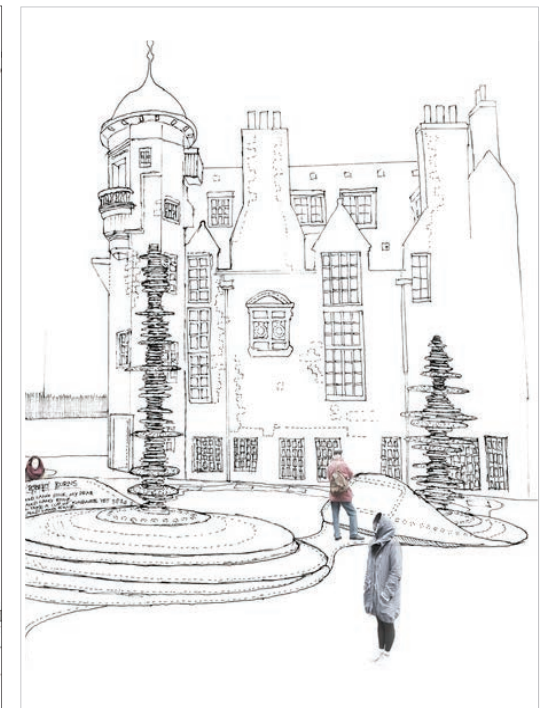
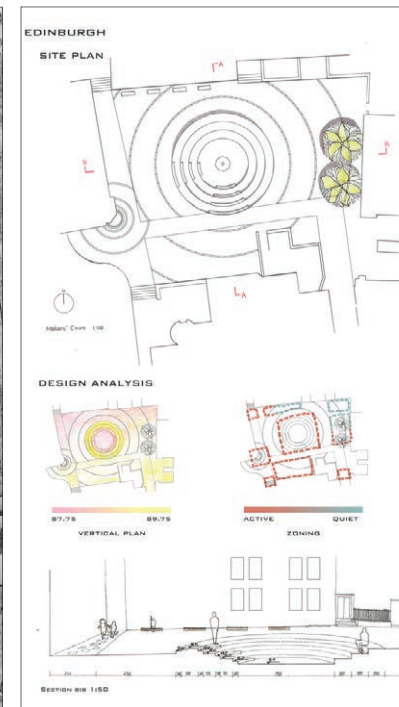

Position: Lecturer and Seminar Leader Client: Edinburgh City Council and Edinburgh World Heritage Trust

This studio-based course introduces beginning MA (undergraduate) and MLA (graduate) students to the fundamental principles, skills, conventions, and theories of contemporary landscape architecture. As lecturer I provide group and individual critiques and lead fieldwork exercises. The students design a real urban site and present ideas to a real client. I also lead a critical reading and writing seminar for the more advanced MLA students. All course content is given through an interactive website, www.ffieldwork.org.

TEACHING EXPERIENCE

Go with Me

50 steps to Landscape Thinking

Within the framework of the
Living landscape Lectureship

Written and edited by:
Thomas Oles
Marieke Timmermans
Jacques Abelman

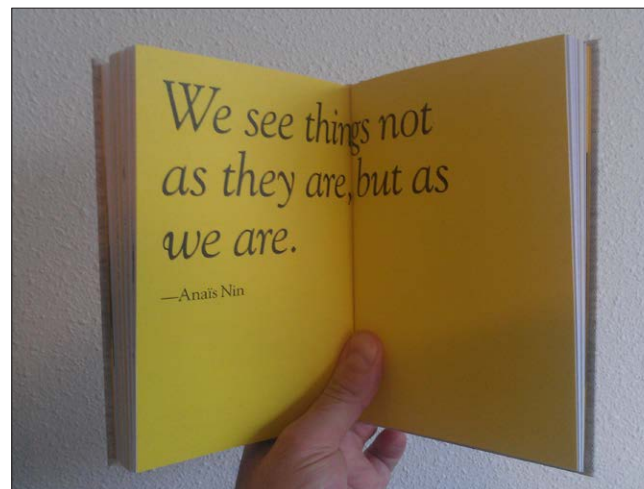
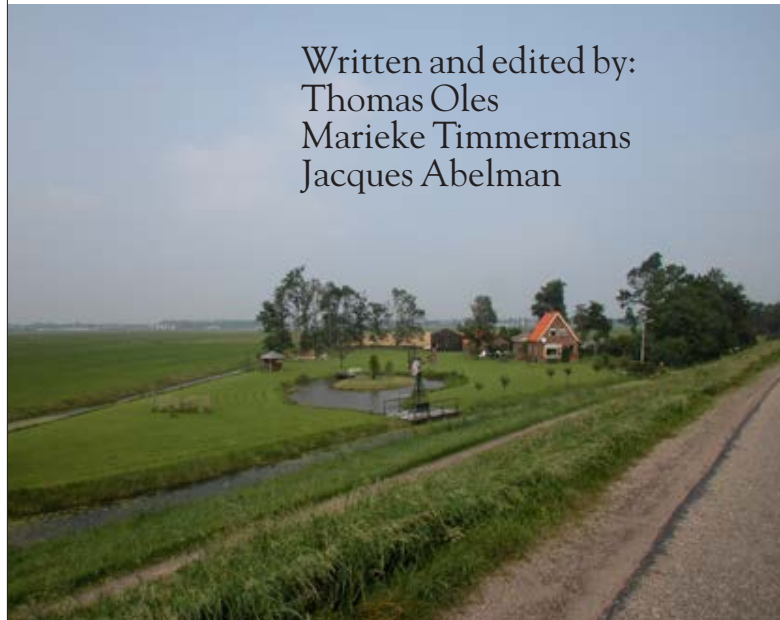
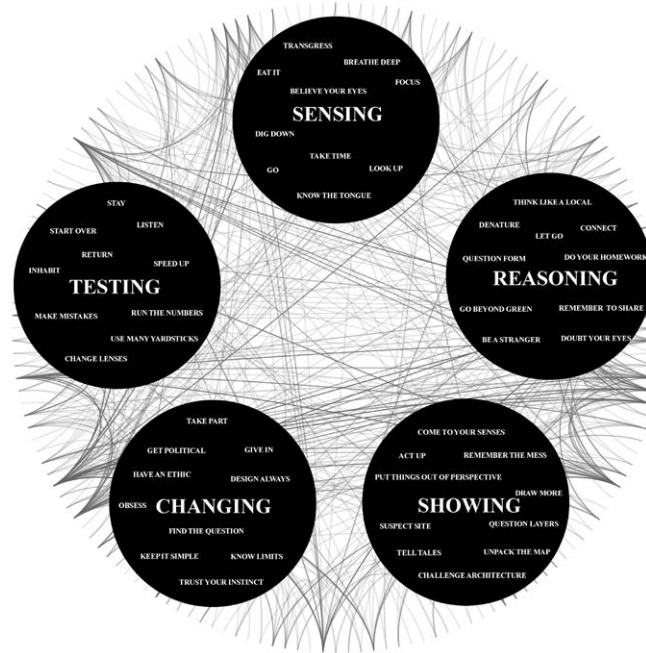

Position: Co-author, Research Assistant, Editor

This handbook or vademecum ("go with me" in Latin) is a guide to fieldwork as well as the main streams of landscape scholarship. As co-author I developed the pedagogical structure and researched sources for each of the fifty chapters or steps. The book moves from positive to normative explorations of landscape, serving as a guide for reflection as well as design and introducing a wider audience to a holistic conception of landscape. Published on Architecture and Natura Press in 2012, the book has sold out.

TEACHING EXPERIENCE

LIVING LANDSCAPE

CAPITA SELECTA 10/11

09.09/ THOMAS OLES
LECTURER ON LIVING LANDSCAPE/ AMSTERDAM ACADEMY OF ARCHITECTURE

16.09/ ALAN BERGER
MASSACHUSETTS INSTITUTE OF TECHNOLOGY/ P-REX

23.09/ CHARLES WALDHEIM
HARVARD GRADUATE SCHOOL OF DESIGN

30.09/ ELEANOR FAWCETT+ MARK BREARLEY
DESIGN FOR LONDON

07.10/ CHRIS REED
STOSS-LU/ LANDSCAPE URBANISM/ BOSTON

14.10/ KEN SMITH
WORKSHOP KEN SMITH/

LIVING LANDSCAPE
WHAT IS LANDSCAPE? WHEN DID THIS WORD COME INTO BEING, AND HOW HAVE ITS MEANINGS CHANGED OVER TIME? WHAT EXPLAINS ITS PROLIFERATION IN RECENT YEARS? AND HOW DO THE ANSWERS TO THESE QUESTIONS SHAPE THE DESIGN AND PLANNING OF PLACES? THIS IS THE SUBJECT OF 'LIVING LANDSCAPE'.

MANY PEOPLE THINK OF LANDSCAPE AS A PLACE FOR AGRICULTURE. ROOTED IN PICTORIAL CONVENTION, THIS VIEW SEES LANDSCAPE AS A RESOURCE THAT CAN BE DRAWN DOWN TO MAKE ROOM FOR 'NON-LANDSCAPE' FUNCTIONS SUCH AS HOUSING OR INDUSTRY. BUT THIS STATIC UNDERSTANDING OF LANDSCAPE IS UNTENABLE IN AN URBANIZED WORLD. A GROWING NUMBER OF SCHOLARS THEREFORE DESCRIBE LANDSCAPE IN TERMS OF HUMAN PRACTICES, INSTITUTIONS, PERCEPTIONS, AND VALUES UNFOLDING IN A PARTICULAR PLACE OVER TIME. IN THIS, MORE DYNAMIC VIEW, LANDSCAPES ARE NOT SIMPLY ZONES LIVED 'IN': THEY ARE THE RESULT OF LIVING.

UNDERSTANDING LANDSCAPE AS LIVED PRACTICE CALLS INTO QUESTION MANY ASSUMPTIONS ABOUT SPACE, OBJECTS, AND REPRESENTATION ON WHICH THE DESIGN PROFESSION RESTS. IT THEREFORE HAS THE POTENTIAL TO TRANSFORM THE PROCESS, PRODUCTS, AND WIDER MISSION OF ARCHITECTURE, LANDSCAPE ARCHITECTURE AND URBAN DESIGN. 'LIVING LANDSCAPE' IS A FORUM FOR EXPLORING THIS TRANSFORMATION AT EVERY SCALE OF THE BUILT ENVIRONMENT, FROM TERRITORY TO BUILDING.

LIVING LANDSCAPE

WORKSHOP

THOMAS OLES / DESIGN ETHICS

AN EXPERIMENTAL EXERCISE / APRIL 26 - MAY 13

Designers rarely take the time to reflect on the assumptions that guide the way they reason and work—in other words, to consider their own ethics.

In design practice there is usually too much to get done, too much to produce in a short time. This lack of speculation often restricts the terms within which design is undertaken.

What are you really doing when you make design choices?

In three phases we will use role playing, games, observation, and concentrated design assignments. The focus will be on drawing as a communicative tool.

You will learn to question your own design process.

Work produced will be included for the Living Landscape Exhibition in the fall, and published in the Living Landscape Vademecum later this year.

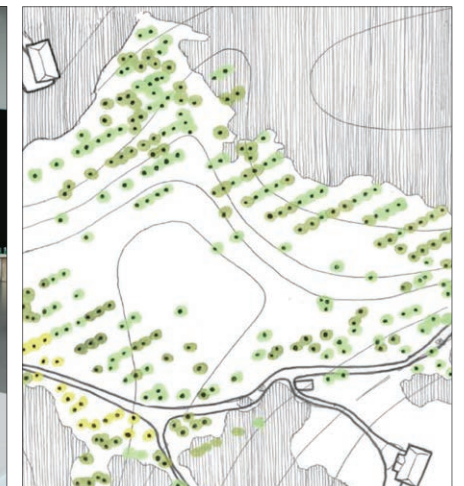

LANDSCAPE IS NOT JUST A PRETTY PICTURE

Donald Markkamp
Jens Meijer
Marit Jansen

Landscape architects design multifunctional landscapes



Position: Instructor, Organizer

For two years I worked closely with Thomas Oles and the head of the landscape architecture department on the designing and teaching of the lectureship. Students were asked to interrogate their own understandings and prejudices with respect to landscape. They attended lectures and seminars by prominent scholars and practitioners, and tackled difficult readings on landscape drawn from the fields of geography, archaeology, art history, and literary studies. They were asked to bring their revised understanding of landscape to bear on design tasks that ranged from urban parks to regional master plans.

TEACHING EXPERIENCE



Position: Lecturer, Organizer of Summer Workshops, Co-ordinator of E-Learning

EMiLA is a consortium of five leading European master's programs formed in order to train cross-cultural leaders in landscape architecture. Students study in at least three different countries and engage current topics in European landscape and policy. I develop and teach an e-learning module dealing with current critical issues and also organize and run summer programs that are hosted by different participating institutions.

TEACHING EXPERIENCE